

TPMS Installation Instructions

1. Determine the mounting location of the receiver.

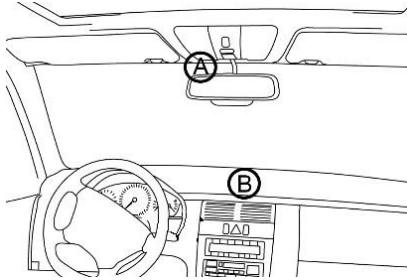

2. Connect loom to receiver and mount as desired using instructions on next page.

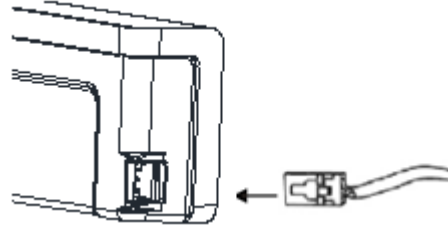

5. **(WIRED)** Connect the wires from the receiver to the vehicle as described.

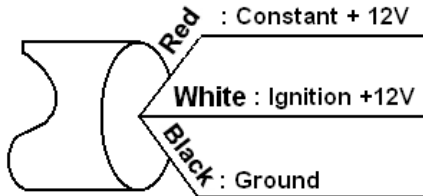

3. Activate the receiver using the instructions on next page.

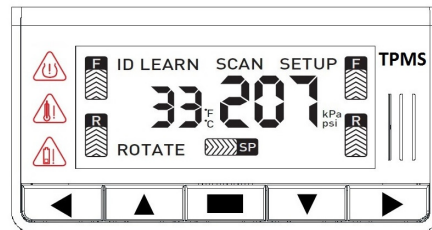

Receiver Activation Procedure

1. Press and hold the ◀ button for 3 or more seconds (when receiver is on) to enter programming mode.
2. For further information, see the instructions.

A : Fit twin adhesive to receiver.

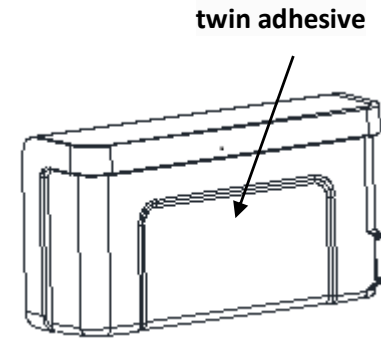

Clean the mounting area using swab supplied. Next, press the tape side to the clean area on the windshield. Hold for 10 seconds

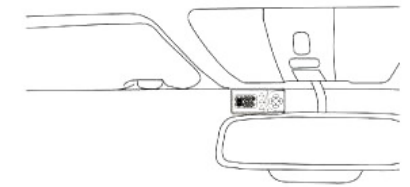

B : Clean using swab supplied. Press double sided tape to the indentation on the bottom of the receiver.

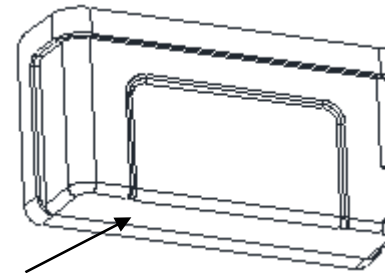

Clean the mounting area using swab supplied. Next, press the tape side to the clean area on the dashboard. Hold for 10 seconds.

